



Braided power conductors



Braided power conductors



Braided flexible powerconnections for any energy-distribution application as per

- Transformers
- Bus duct systems
- Electrical panels
- Generators
- Units power supply
- Rectifiers
- Renewable energies
- Railway applications

Type of conductor	Coating on conductor	Coating on terminals	Special treatment	Insulation	
F	R	R	HTD	PVC	PVC Tube
Flat braid	Bare copper	Bare copper	Hot Tin Dipped	HPE	Heat shrinkable sleeve
R	T	T		SIL	Silicon sleeve
Round braid	Tinned copper	Tinned copper		GFI	Glass fiber insulation
T		S		RTI	Rubber Tube Insulation
Twisted cable		Silver plating		SGF	Silicon Glass Fiber
		N		BPS	Braided Polyamide Sleeve
		Nickel plating		SPI	Squared PVC Insulation

Main characteristics

Power conductors made of braided electrolytic copper wire with contact-pressed ends. Wire diameter of 0.2 mm (CU-ETP UNI EN 13602), which results in high flexibility and high vibration resistance. The contact-pressed ends (CU-DHP UNI EN 12499) can be drilled as needed or clamped to the connecting flag using Mericon's BC connection-clamp. The end terminals can be provided bare or with tin, silver or nickel plating.

Cross section from 10 up to 5 000 mm², terminal width from 8 up to 200 mm. Special braid materials e. g. aluminium, special dimensions and structure are available on demand.

If two parallel flexes are used, the distance between them must be equal to the thickness of the conductors (minimum).

Design

We are happy to help you with the design of your application and braid, from standard to special dimensions.

Contact us for support, together we find a solution that works both technically, functionally and visually if necessary.

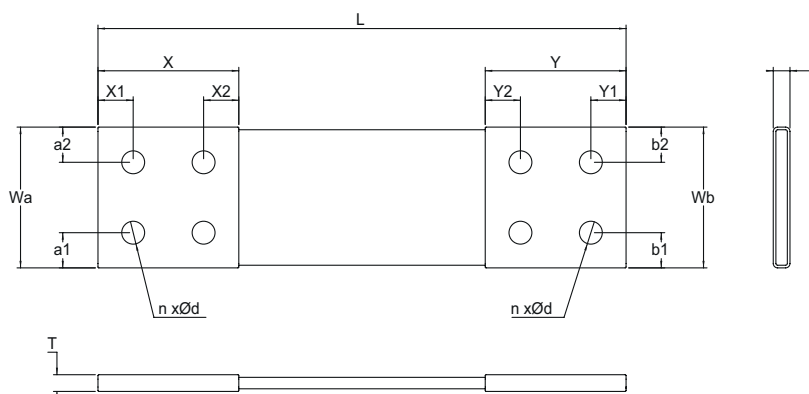

You can design your own braid. Use sample drawing and enter the desired dimensions according to the table below. Or contact us and we will help you.

Type	Cross section	wire	L	Wa	a2	X	x1	x2	Wb	b1	b2	Y	y1	y2	ØD
	mm ²					dimensions in mm									
FRR	800	0,20	1 000	100	25	100	25	25	100	25	25	120	30	30	14
FRT	1 000	0,20	450	120	30	150	40	40	160	40	40	160	40	40	13
FTT	2 500	0,20	810	160	40	140	30	30	160	30	30	140	30	30	15
relative ordering code															
FRR 800/020-1 000/100				FRT 1 000/020-450/120-160						FRT 2 500/020-810/160					

Standard drilling patterns

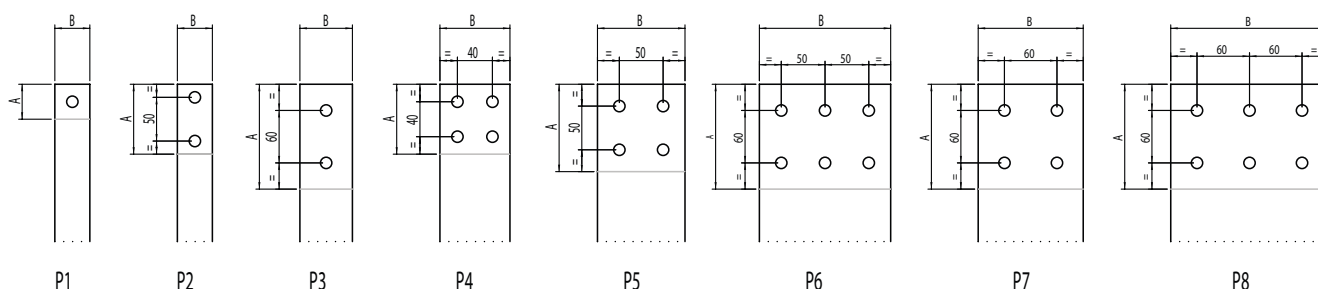

Braided power conductors

Bare copper	Tin-plated copper	Cross section mm ²	L	X	W	t	Current load ΔT 50°C	
							dimensions in mm	
FRT 10/020-200/10	FTT 10/020-200/10	10	200	10	10	3,5	110 A	189 A
FRT 10/020-200/12	FTT 10/020-200/12	10	200	12	12	3,2	110 A	189 A
FRT 16/020-200/15	FTT 16/020-200/15	16	200	15	15	3,5	160 A	275 A
FRT 16/020-200/17	FTT 16/020-200/17	16	200	17	17	3,3	160 A	275 A
FRT 25/020-200/20	FTT 25/020-200/20	25	200	20	20	3,7	210 A	361 A
FRT 25/020-200/22	FTT 25/020-200/22	25	200	22	22	3,5	220 A	378 A
FRT 25/020-200/25	FTT 25/020-200/25	25	200	25	25	3,3	220 A	378 A
FRT 35/020-200/22	FTT 35/020-200/22	35	200	22	22	4,1	260 A	447 A
FRT 35/020-200/25	FTT 35/020-200/25	35	200	25	25	3,8	270 A	464 A
FRT 50/020-200/25	FTT 50/020-200/25	50	200	25	25	4,6	320 A	550 A
FRT 50/020-200/30	FTT 50/020-200/30	50	200	30	30	4,2	340 A	585 A
FRT 50/020-250/35	FTT 50/020-250/35	50	250	35	35	3,8	350 A	602 A
FRT 75/020-200/30	FTT 75/020-200/30	75	200	30	30	5,2	420 A	722 A
FRT 75/020-250/35	FTT 75/020-250/35	75	250	35	35	4,8	440 A	757 A
FRT 100/020-200/30	FTT 100/020-200/30	100	200	30	30	6	490 A	843 A
FRT 100/020-250/35	FTT 100/020-250/35	100	250	35	35	5,6	510 A	877 A
FRT 100/020-250/40	FTT 100/020-250/40	100	250	40	40	5,2	530 A	912 A
FRT 120/020-200/30	FTT 120/020-200/30	120	200	30	30	7	540 A	929 A
FRT 120/020-250/35	FTT 120/020-250/35	120	250	35	35	6,5	560 A	963 A
FRT 120/020-250/40	FTT 120/020-250/40	120	250	40	40	6	580 A	998 A
FRT 150/020-200/30	FTT 150/020-200/30	150	200	30	30	8	610 A	1 049 A
FRT 150/020-250/35	FTT 150/020-250/35	150	250	35	35	7,5	630 A	1 084 A
FRT 150/020-250/40	FTT 150/020-250/40	150	250	40	40	6,8	650 A	1 118 A
FRT 150/020-250/45	FTT 150/020-250/45	150	250	45	45	6,2	670 A	1 152 A
FRT 200/020-300/40	FTT 200/020-300/40	200	300	40	40	8,3	760 A	1 307 A
FRT 200/020-300/45	FTT 200/020-300/45	200	300	45	45	7,6	780 A	1 342 A
FRT 200/020-300/50	FTT 200/020-300/50	200	300	50	50	7	810 A	1 393 A
FRT 200/020-350/40	FTT 200/020-350/40	200	350	100	40	8,3	760 A	1 307 A
FRT 200/020-350/50	FTT 200/020-350/50	200	350	100	50	7	780 A	1 342 A
FRT 250/020-300/40	FTT 250/020-300/40	250	300	40	40	10	860 A	1 479 A
FRT 250/020-300/45	FTT 250/020-300/45	250	300	45	45	9	890 A	1 531 A
FRT 250/020-300/50	FTT 250/020-300/50	250	300	50	50	8,3	910 A	1 565 A
FRT 250/020-350/40	FTT 250/020-350/40	250	350	100	40	10	860 A	1 479 A
FRT 250/020-350/50	FTT 250/020-350/50	250	350	100	50	8,3	910 A	1 565 A
FRT 300/020-300/45	FTT 300/020-300/45	300	300	45	45	10,6	980 A	1 686 A
FRT 300/020-300/50	FTT 300/020-300/50	300	300	50	50	9,5	1 000 A	1 720 A
FRT 300/020-300/60	FTT 300/020-300/60	300	300	60	60	8,5	1 050 A	1 806 A
FRT 300/020-400/45	FTT 300/020-400/45	300	400	80	45	10,6	980 A	1 686 A
FRT 300/020-400/50	FTT 300/020-400/50	300	400	100	50	9,5	1 000 A	1 720 A
FRT 300/020-400/60	FTT 300/020-400/60	300	400	120	60	8,5	1 050 A	1 806 A
FRT 300/020-400/70	FTT 300/020-400/70	300	400	120	70	8,3	1 110 A	1 909 A
FRT 400/020-300/50	FTT 400/020-300/50	400	300	50	50	12	1 180 A	2 030 A
FRT 400/020-400/40	FTT 400/020-400/40	400	400	80	40	15	1 130 A	1 944 A
FRT 400/020-400/50	FTT 400/020-400/50	400	400	100	50	12	1 180 A	2 030 A
FRT 400/020-400/60	FTT 400/020-400/60	400	400	120	60	10,5	1 230 A	2 116 A



Braided power conductors

Bare copper	Tin-plated copper	Cross section	L	X	W	t	Current load ΔT 50°C	
							mm ²	dimensions in mm
FRT 400/020-400/80	FTT 400/020-400/80	400	400	80	80	9,5	1 340 A	2 305 A
FRT 400/020-400/100	FTT 400/020-400/100	400	400	100	100	8	1 430 A	2 460 A
FRT 400/020-400/120	FTT 400/020-400/120	400	400	120	120	7	1 520 A	2 614 A
FRT 500/020-400/50	FTT 500/020-400/50	500	400	100	50	14,5	1 330 A	2 288 A
FRT 500/020-400/60	FTT 500/020-400/60	500	400	120	60	12,5	1 390 A	2 391 A
FRT 500/020-400/80	FTT 500/020-400/80	500	400	80	80	11	1 510 A	2 597 A
FRT 500/020-400/90	FTT 500/020-400/90	500	400	120	90	10	1 560 A	2 683 A
FRT 500/020-400/100	FTT 500/020-400/100	500	400	100	100	9,2	1 610 A	2 769 A
FRT 500/020-450/120	FTT 500/020-450/120	500	450	120	120	8,5	1 720 A	2 958 A
FRT 500/020-450/140	FTT 500/020-450/140	500	450	120	140	8,5	1 800 A	3 096 A
FRT 500/020-450/150	FTT 500/020-450/150	500	450	120	150	7	1 840 A	3 165 A
FRT 500/020-450/160	FTT 500/020-450/160	500	450	120	160	9	1 890 A	3 251 A
FRT 500/020-500/200	FTT 500/020-500/200	500	500	120	200	9	2 040 A	3 509 A
FRT 600/020-400/60	FTT 600/020-400/60	600	400	100	60	16	1 550 A	2 666 A
FRT 600/020-400/70	FTT 600/020-400/70	600	400	120	70	14	1 600 A	2 752 A
FRT 600/020-400/80	FTT 600/020-400/80	600	400	80	80	12,5	1 660 A	2 855 A
FRT 600/020-400/90	FTT 600/020-400/90	600	400	120	90	11,5	1 720 A	2 958 A
FRT 600/020-400/100	FTT 600/020-400/100	600	400	100	100	10,5	1 770 A	3 044 A
FRT 600/020-450/120	FTT 600/020-450/120	600	450	120	120	9,5	1 880 A	3 234 A
FRT 600/020-450/140	FTT 600/020-450/140	600	450	120	140	9,3	1 980 A	3 406 A
FRT 600/020-450/150	FTT 600/020-450/150	600	450	120	150	8	2 020 A	3 474 A
FRT 600/020-450/160	FTT 600/020-450/160	600	450	120	160	8	2 060 A	3 543 A
FRT 600/020-450/180	FTT 600/020-450/180	600	450	120	180	9	2 150 A	3 698 A
FRT 600/020-500/200	FTT 600/020-500/200	600	500	120	200	10	2 240 A	3 853 A
FRT 800/020-400/80	FTT 800/020-400/80	800	400	80	80	15,5	1 940 A	3 337 A
FRT 800/020-400/100	FTT 800/020-400/100	800	400	100	100	13	2 060 A	3 543 A
FRT 800/020-450/120	FTT 800/020-450/120	800	450	120	120	11,5	2 180 A	3 750 A
FRT 800/020-450/140	FTT 800/020-450/140	800	450	120	140	11	2 290 A	3 939 A
FRT 800/020-450/150	FTT 800/020-450/150	800	450	120	150	10	2 340 A	4 025 A
FRT 800/020-450/160	FTT 800/020-450/160	800	450	120	160	11,5	2 400 A	4 128 A
FRT 800/020-450/180	FTT 800/020-450/180	800	450	120	180	10,5	2 490 A	4 283 A
FRT 800/020-500/200	FTT 800/020-500/200	800	500	120	200	11	2 590 A	4 455 A
FRT 1000/020-450/80	FTT 1000/020-450/80	1 000	450	80	80	19	2 200 A	3 784 A
FRT 1000/020-450/100	FTT 1000/020-450/100	1 000	450	100	100	15,5	2 320 A	3 990 A
FRT 1000/020-450/120	FTT 1000/020-450/120	1 000	450	120	120	14,5	2 450 A	4 214 A
FRT 1000/020-500/140	FTT 1000/020-500/140	1 000	500	120	140	13	2 570 A	4 420 A
FRT 1000/020-500/150	FTT 1000/020-500/150	1 000	500	120	150	13,3	2 630 A	4 524 A
FRT 1000/020-500/160	FTT 1000/020-500/160	1 000	500	120	160	12,8	2 690 A	4 627 A
FRT 1000/020-500/180	FTT 1000/020-500/180	1 000	500	120	180	12,0	2 800 A	4 816 A
FRT 1000/020-500/200	FTT 1000/020-500/200	1 000	500	120	200	12,5	2 900 A	4 988 A
FRT 1200/020-450/100	FTT 1200/020-450/100	1 200	450	100	100	18	2 560 A	4 403 A
FRT 1200/020-450/120	FTT 1200/020-450/120	1 200	450	120	120	16,5	2 700 A	4 644 A
FRT 1200/020-500/140	FTT 1200/020-500/140	1 200	500	120	140	14,6	2 830 A	4 868 A
FRT 1200/020-500/150	FTT 1200/020-500/150	1 200	500	120	150	15	2 900 A	4 988 A
FRT 1200/020-500/160	FTT 1200/020-500/160	1 200	500	120	160	14,3	2 960 A	5 091 A



Braided power conductors

Bare copper	Tin-plated copper	Cross section	L	X	W	t	Current load $\Delta T 50^{\circ}C$	
							mm ²	dimensions in mm
FRT 1200/020-500/180	FTT 1200/020-500/180	1 200	500	120	180	13,5	3 070 A	5 280 A
FRT 1200/020-500/200	FTT 1200/020-500/200	1 200	500	120	200	13,5	3 180 A	5 470 A
FRT 1500/020-450/100	FTT 1500/020-450/100	1 500	450	120	100	22	2 900 A	4 988 A
FRT 1500/020-450/120	FTT 1500/020-450/120	1 500	450	120	120	20	3 050 A	5 246 A
FRT 1500/020-500/140	FTT 1500/020-500/140	1 500	500	120	140	16,2	3 180 A	5 470 A
FRT 1500/020-500/150	FTT 1500/020-500/150	1 500	500	120	150	17,5	3 260 A	5 607 A
FRT 1500/020-500/160	FTT 1500/020-500/160	1 500	500	120	160	16,6	3 320 A	5 710 A
FRT 1500/020-500/180	FTT 1500/020-500/180	1 500	500	120	180	15,5	3 440 A	5 917 A
FRT 1500/020-500/200	FTT 1500/020-500/200	1 500	500	120	200	15,5	3 570 A	6 140 A
FRT 1800/020-450/120	FTT 1800/020-450/120	1 800	450	120	120	23	3 370 A	5 796 A
FRT 1800/020-500/140	FTT 1800/020-500/140	1 800	500	120	140	19	3 500 A	6 020 A
FRT 1800/020-500/150	FTT 1800/020-500/150	1 800	500	120	150	20	3 590 A	6 175 A
FRT 1800/020-500/160	FTT 1800/020-500/160	1 800	500	120	160	19	3 660 A	6 295 A
FRT 1800/020-500/180	FTT 1800/020-500/180	1 800	500	120	180	17,5	3 790 A	6 519 A
FRT 1800/020-500/200	FTT 1800/020-500/200	1 800	500	120	200	17,5	3 930 A	6 760 A
FRT 2000/020-450/120	FTT 2000/020-450/120	2 000	450	120	120	25	3 570 A	6 140 A
FRT 2000/020-500/140	FTT 500/020-450/160	500	450	120	160	9	1 890 A	3 251 A
FRT 500/020-500/200	FTT 500/020-500/200	500	500	120	200	9	2 040 A	3 509 A
FRT 600/020-400/60	FTT 2000/020-500/140	2 000	500	120	140	21	3 710 A	6 381 A
FRT 2000/020-500/150	FTT 2000/020-500/150	2 000	500	120	150	22	3 800 A	6 536 A
FRT 2000/020-500/160	FTT 2000/020-500/160	2 000	500	120	160	21	3 870 A	6 656 A
FRT 2000/020-500/180	FTT 2000/020-500/180	2 000	500	120	180	19	4 010 A	6 897 A
FRT 2000/020-500/200	FTT 2000/020-500/200	2 000	500	120	200	18,5	4 150 A	7 138 A
FRT 2200/020-500/140	FTT 2200/020-450/120	2 200	450	120	120	27	3 760 A	6 467 A
FRT 600/020-450/140	FTT 2200/020-500/140	2 200	500	120	140	24,5	3 920 A	6 742 A
FRT 600/020-450/150	FTT 600/020-450/150	600	450	120	150	8	2 020 A	3 474 A
FRT 600/020-450/160	FTT 600/020-450/160	600	450	120	160	8	2 060 A	3 543 A
FRT 600/020-450/180	FTT 600/020-450/180	600	450	120	180	9	2 150 A	3 698 A
FRT 600/020-500/200	FTT 600/020-500/200	600	500	120	200	10	2 240 A	3 853 A
FRT 2200/020-500/150	FTT 2200/020-500/150	2 200	500	120	150	23,5	4 000 A	6 880 A
FRT 2200/020-500/160	FTT 2200/020-500/160	2 200	500	120	160	22	4 070 A	7 000 A
FRT 2200/020-500/180	FTT 2200/020-500/180	2 200	500	120	180	21,5	4 220 A	7 258 A
FRT 2200/020-500/200	FTT 2200/020-500/200	2 200	500	120	200	20	4 360 A	7 499 A
FRT 2400/020-450/120	FTT 2400/020-450/120	2 400	450	120	120	29	3 950 A	6 794 A
FRT 2400/020-500/140	FTT 2400/020-500/140	2 400	500	120	140	26,5	4 110 A	7 069 A
FRT 2400/020-500/150	FTT 2400/020-500/150	2 400	500	120	150	25	4 190 A	7 207 A
FRT 2400/020-500/160	FTT 2400/020-500/160	2 400	500	120	160	24	4 260 A	7 327 A
FRT 2400/020-500/180	FTT 2400/020-500/180	2 400	500	120	180	23	4 420 A	7 602 A
FRT 2400/020-500/200	FTT 2400/020-500/200	2 400	500	120	200	20	4 550 A	7 826 A
FRT 3000/020-450/120	FTT 3000/020-450/120	3 000	450	120	120	33,5	4 460 A	7 671 A
FRT 3000/020-500/140	FTT 3000/020-500/140	3 000	500	120	140	32	4 650 A	7 998 A
FRT 3000/020-500/150	FTT 3000/020-500/150	3 000	500	120	150	30	4 730 A	8 136 A
FRT 3000/020-500/160	FTT 3000/020-500/160	3 000	500	120	160	28,5	4 810 A	8 273 A
FRT 3000/020-500/180	FTT 3000/020-500/180	3 000	500	120	180	27	4 980 A	8 566 A
FRT 3000/020-500/200	FTT 3000/020-500/200	3 000	500	120	200	24	5 130 A	8 824 A

Bare copper	Tin-plated copper	Cross section	L	X	W	t	Current load $\Delta T 50^{\circ}C$	
							mm ²	dimensions in mm
FRT 3600/020-450/120	FTT 3600/020-450/120	3 600	450	120	120	40	4 960 A	8 531 A
FRT 3600/020-500/140	FTT 3600/020-500/140	3 600	500	120	140	37	5 150 A	8 858 A
FRT 3600/020-500/150	FTT 3600/020-500/150	3 600	500	120	150	35	5 230 A	8 996 A
FRT 3600/020-500/160	FTT 3600/020-500/160	3 600	500	120	160	33	5 320 A	9 150 A
FRT 3600/020-500/180	FTT 3600/020-500/180	3 600	500	120	180	31	5 490 A	9 443 A
FRT 3600/020-500/200	FTT 3600/020-500/200	3 600	500	120	200	27,5	5 650 A	9 718 A
FRT 4500/020-450/120	FTT 4500/020-450/120	4 500	450	120	120	50	5 670 A	9 752 A
FRT 4500/020-500/150	FTT 4500/020-500/150	4 500	500	120	150	42,5	5 940 A	10 217 A
FRT 4500/020-500/160	FTT 4500/020-500/160	4 500	500	120	160	41	6 030 A	10 372 A
FRT 4500/020-500/180	FTT 4500/020-500/180	4 500	500	120	180	36	6 190 A	10 647 A
FRT 4500/020-500/200	FTT 4500/020-500/200	4 500	500	120	200	33	6 370 A	10 956 A
FRT 5000/020-450/100	FTT 5000/020-450/100	5 000	450	120	100	68	5 950 A	10 234 A
FRT 5000/020-450/120	FTT 5000/020-450/120	5 000	450	120	120	55	6 040 A	10 389 A
FRT 5000/020-450/140	FTT 5000/020-450/140	5 000	450	120	140	50	6 230 A	10 716 A
FRT 5000/020-450/160	FTT 5000/020-450/160	5 000	450	120	160	48	6 440 A	11 077 A
FRT 5000/020-450/180	FTT 5000/020-450/180	5 000	450	120	180	45	6 630 A	11 404 A
FRT 5000/020-450/200	FTT 5000/020-450/200	5 000	450	120	200	36	6 750 A	11 610 A





mericon

Mericon Sverige AB
Bivägen 4
SE-663 41 Hammarö

info@mericon.se
mericon.se
+46 (0)54-250 59 00

Welcome to our webshop!

